

MASTER PLAN APPENDIX

1. Green Village Historic District
2. Hartley Farms Historic District
3. Logansville Historic District
4. New Vernon Historic District
5. Pleasantville Historic District
6. Silver Lake Historic District
7. Tempe Wick Historic District
8. List of Individual Properties of Historic Significance

Harding Township

Green Village Historic District

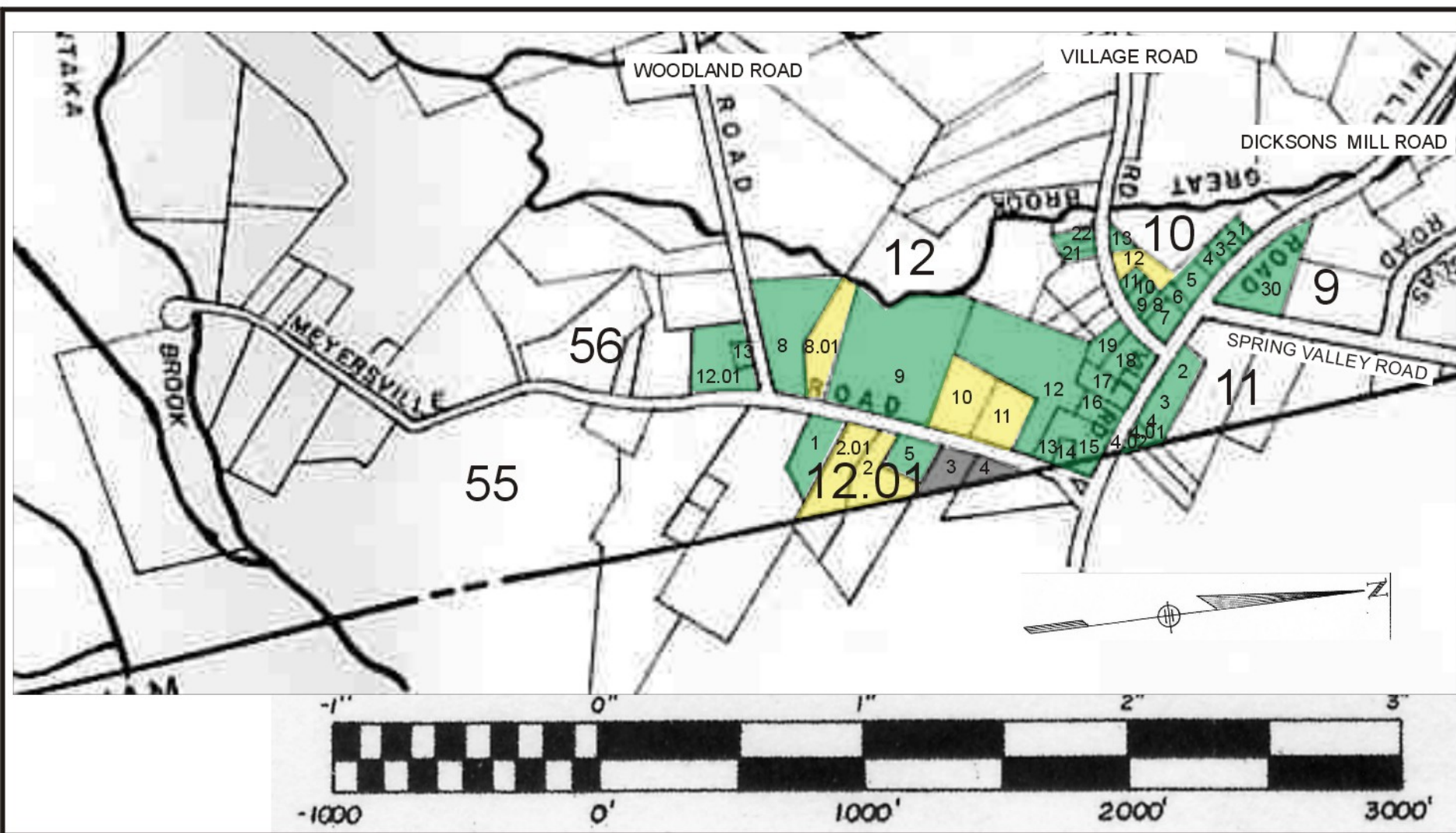

Contributing



Non-Contributing



Vacant

THE HARTLEY FARMS PLAN

The intent of the Hartley Farms Plan is to preserve the unique character of this historic property. This plan has received national recognition for its award winning design. The number of homes has been determined by site character rather than zoning regulations. Houses are nestled along existing and new hedgerows, overlooking woodlands and open meadows, further protected by common open spaces and conservation easements.

LOT #	ACREAGE	LOT #	ACREAGE
1. Hartley House	6.2 acres	* 49. The Hay Fields	3.5 acres
31. Deer Grass Field	3.2 acres	* 50. The Hay Fields	4.0 acres
32. Apple Orchard	5.4 acres	* 51. The Hay Fields	3.7 acres
33. Stone House	4.6 acres	52. Battleground	4.0 acres
34. Pear Orchard	4.5 acres	* 53. Battleground	7.0 acres
35. Two Shoes	3.6 acres	+ 54. Remington Forest	23.7 acres
36. Lane House	3.3 acres	55. Dog Show Corner	3.2 acres
37. Stable Cottage	3.1 acres	56. Leaf Trees	3.2 acres
+ 38. Polo Fields	13.0 acres	57. Leaf Trees	4.0 acres
39. Forest Edge	3.8 acres	58. Blue Mill Field	4.0 acres
40. Forest Edge	3.7 acres	59. Blue Mill Field	3.7 acres
* 43. Mayfield	3.3 acres	60. Blue Mill Field	3.3 acres
* 44. The High Point	3.5 acres	61. Tall Trees	4.2 acres
* 45. The High Point	3.5 acres	62. Violet Field	3.8 acres
* 46. Mayfield	3.5 acres	64. Violet Field	4.0 acres
* 47. The Paddocks	3.0 acres	65. Thanksgiving Field	5.5 acres
* 48. The Paddocks	3.0 acres	66. Thanksgiving Field	4.1 acres

* Phase 1
+ Open Space

□ Home Sites

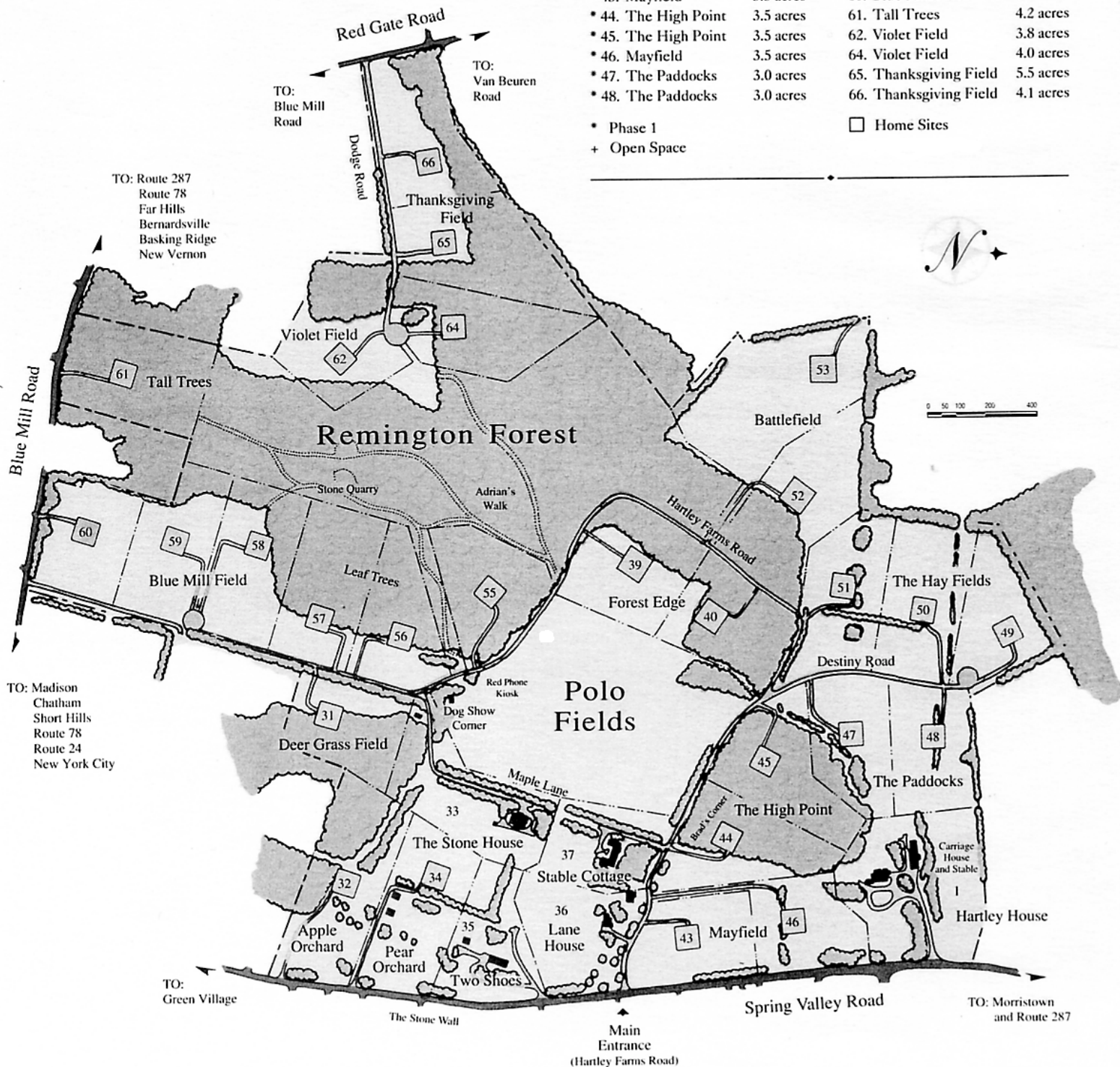

Harding Township

Logansville Locally-Designated Historic District

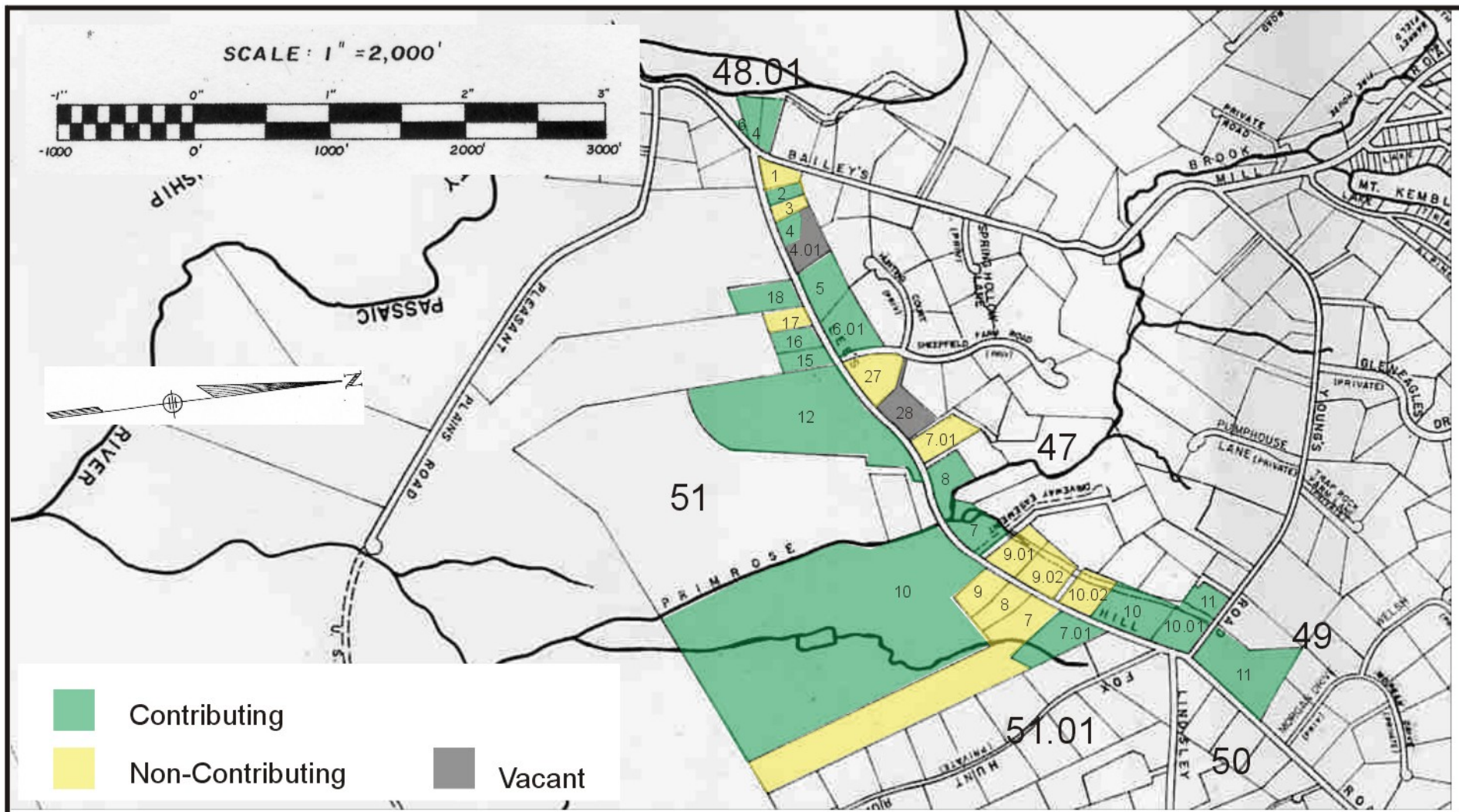

Harding Township

New Vernon Historic District

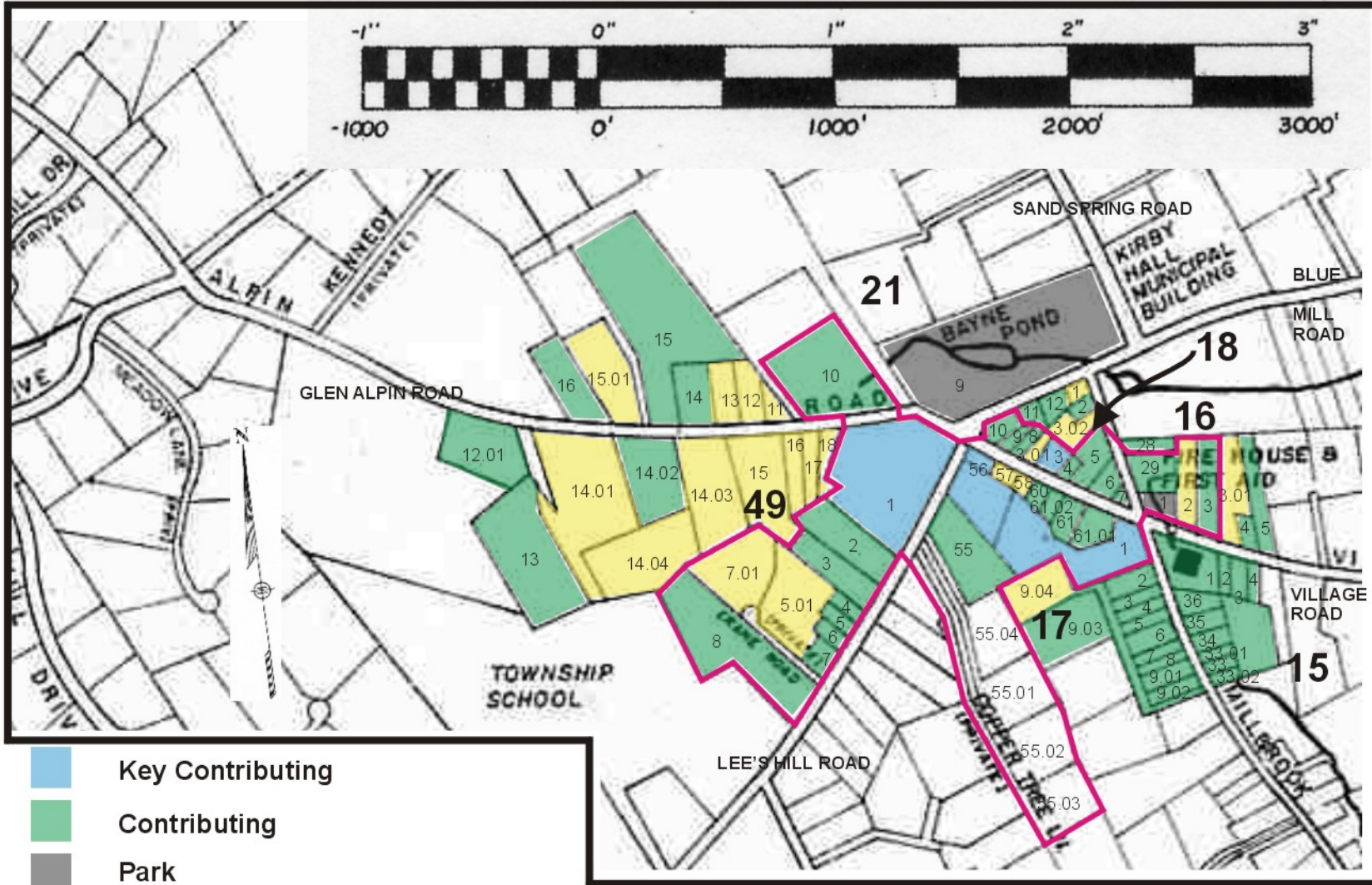

- Key Contributing
- Contributing
- Park
- Non-Contributing
- Boundary of the New Jersey and National Register Historic District

Note: Block 17, Lots 55.01, 55.02, 55.03 and 55.04 were still part of Block 17, Lot 55 when that lot was listed as part of the National Register district. As a result they fall within the NR district. However, the buildings on these lots are modern houses, so the subdivision has not been included in the municipal historic district.

Harding Township

Pleasantville Historic District

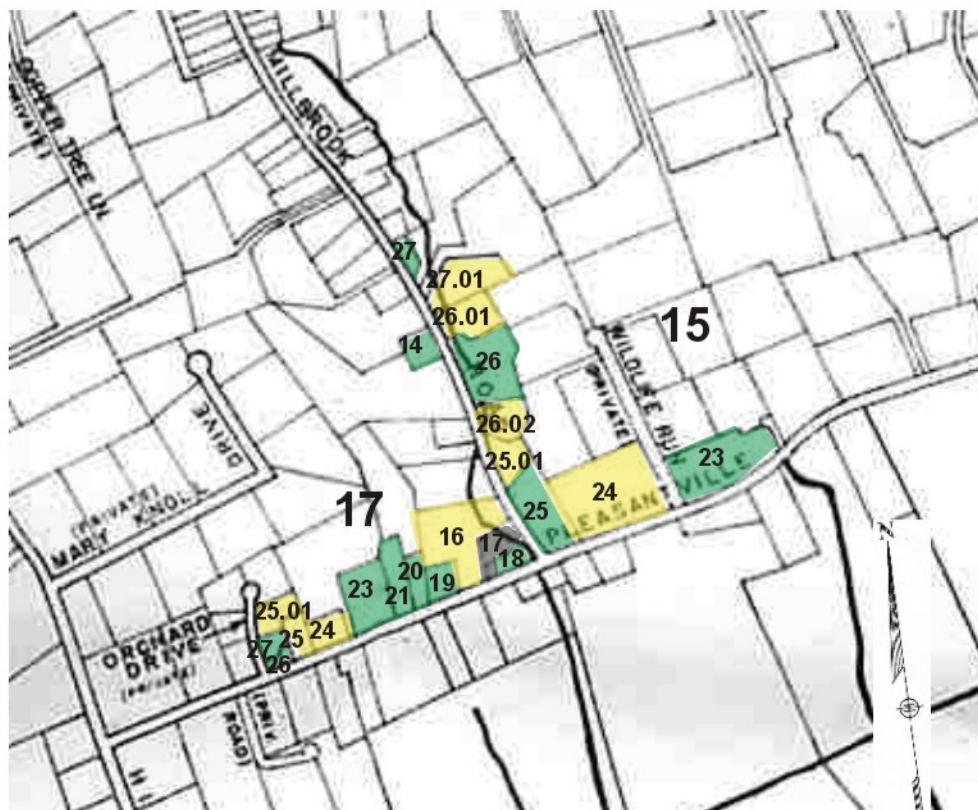

SCALE: 1" = 2,000'



Contributing



Vacant

Non-Contributing

Harding Township

Tempe Wick Historic District

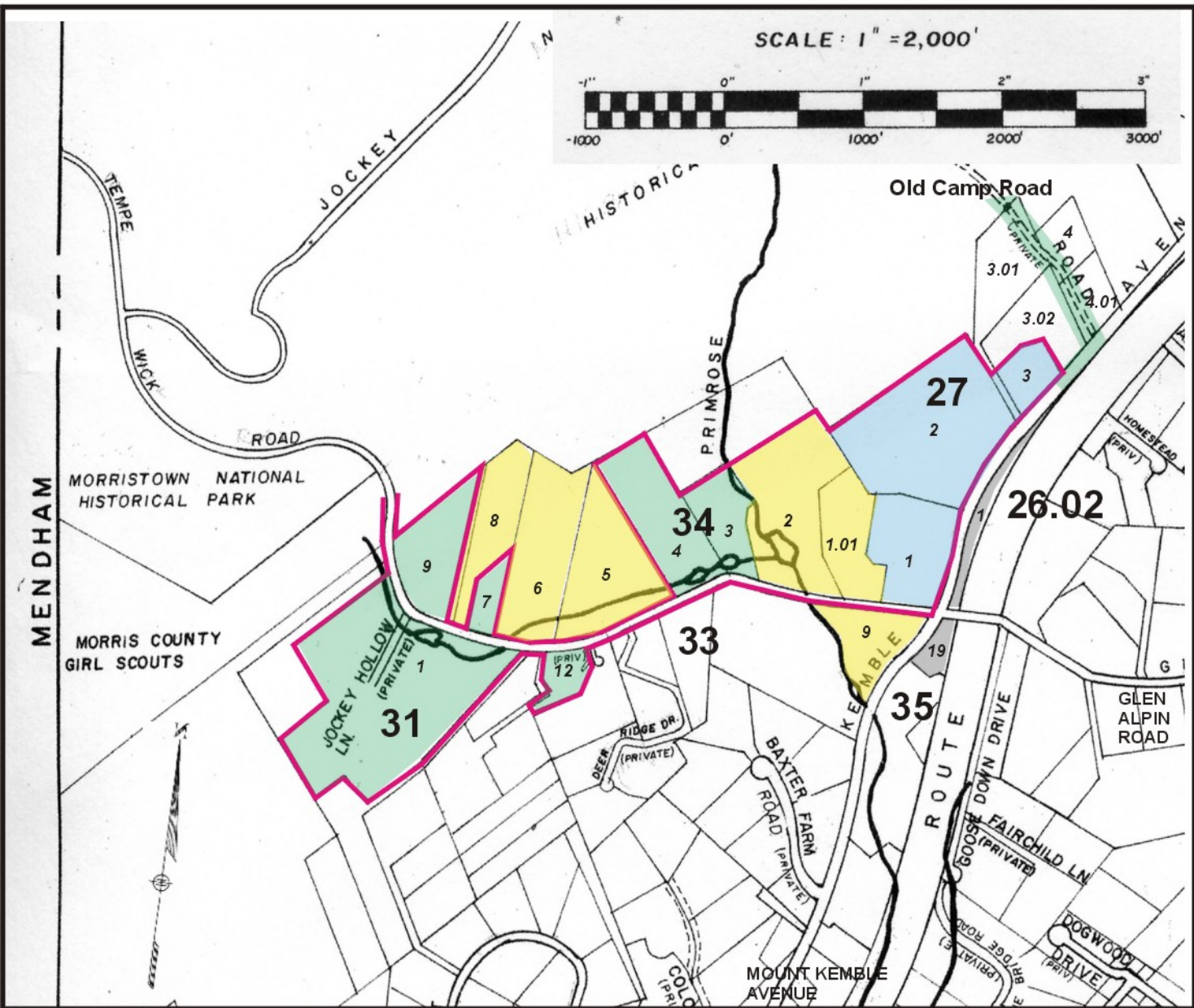

Key Contributing Contributing Non-Contributing Vacant

Boundary of the New Jersey & National Registers Historic District

Note: the Tempe Wick NJ & National Register Historic District Continues up Tempe Wick Road into the Morristown National Historic Park and across the town line into Mendham.

4

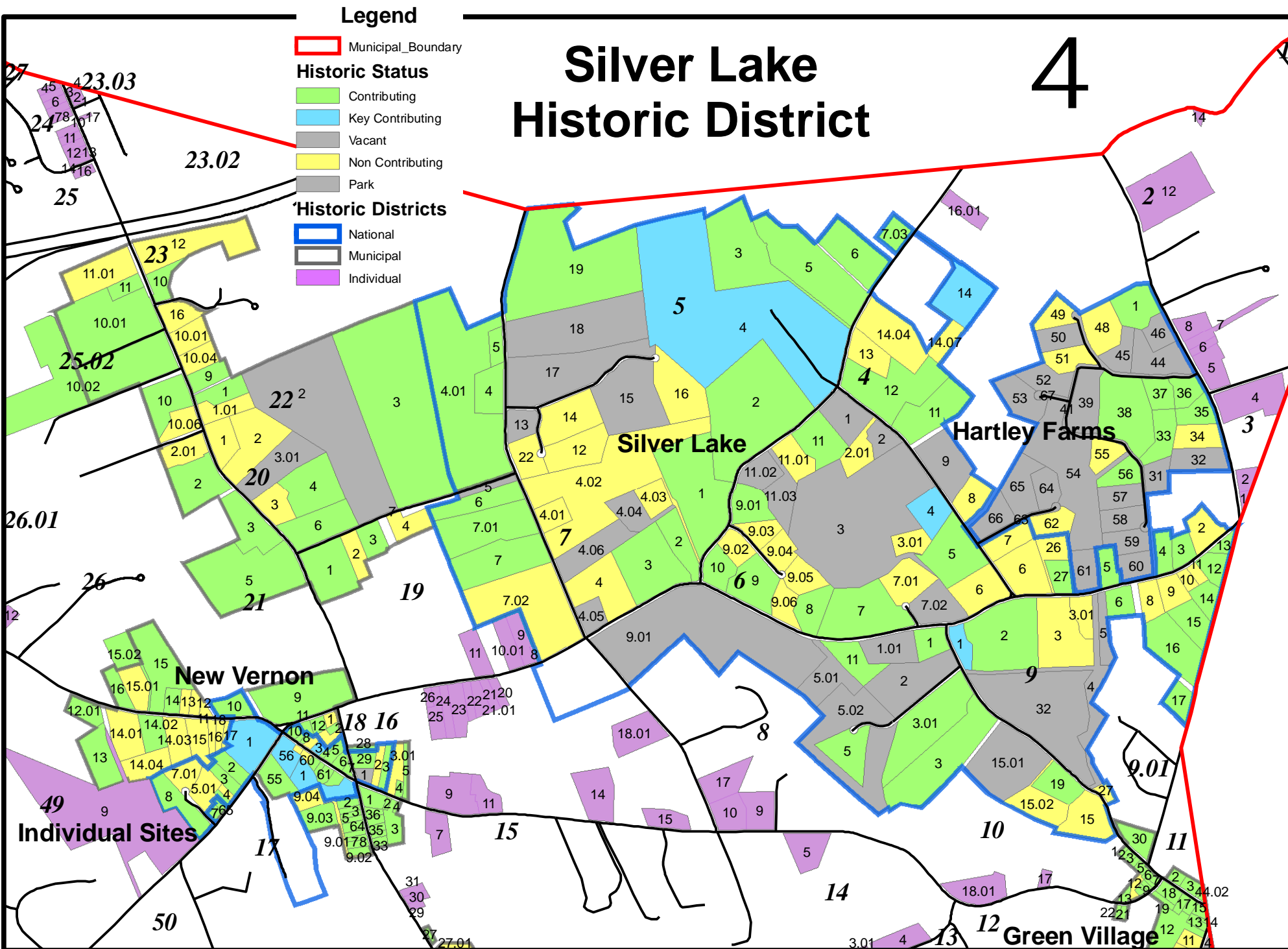

Individual Properties of Historic Significance

Block	Lot	Street	Status
1	2	26 Kitchell Road	Contributing
1	7	44 Kitchell Road	Contributing
1	8	50 Kitchell Road	Contributing
1	8.01	48 Kitchell Road	Contributing
2	5	622 Spring Valley Road	Contributing
2	6	630 Spring Valley Road	Contributing
2	7	632 Spring Valley Road	Contributing
2	8	638 Spring Valley Road	Contributing
2	12	668 Spring Valley Road	Contributing
2	14	110 Kitchell Road	Contributing
3	1	592 Spring Valley Road	Contributing
3	2	596 Spring Valley Road	Contributing
3	4	614 Spring Valley Road	Contributing
4	16.01	612 Van Beuren Road	Contributing
4	16.01	612 Van Beuren Road	Contributing
4	26	201 Blue Mill Road	Contributing
8	9	117 Village Road	Contributing
8	10	111 Village Road	Contributing
8	17	45 Featherbed Lane	Contributing
10	17	195 Village Road	Contributing
10	18.01	165 Village Road	Contributing
12	4	48 Woodland Road	Contributing
12	7	12 Woodland Road	Contributing
12	28	17 Miller Road	Contributing
13	1.01	72 Woodland Road	Contributing
13	7	14 Miller Road	Contributing
14	1.01	121 Pleasantville Road	Contributing
14	3.01	147 Pleasantville Road	Contributing
14	4	153 Pleasantville Road	Contributing
14	5	126 Village Road	Contributing
15	7	42 Village Road	Contributing
15	21.04	95 Pleasantville Road	Contributing
15	29	53 Millbrook Road	Contributing
15	30	49 Millbrook Road	Contributing
15	31	47 Millbrook Road	Contributing
16	9	45 Village Road	Contributing
16	11	55 Village Road	Contributing
16	14	81 Village Road	Contributing
16	15	93 Village Road	Contributing
16	18.01	22 Featherbed Lane	Contributing
16	20	52 Blue Mill Road	Contributing
16	21	50 Blue Mill Road	Contributing
16	21.01	48 Blue Mill Road	Contributing
16	22	46 Blue Mill Road	Contributing
16	23	42 Blue Mill Road	Contributing
16	24	38 Blue Mill Road	Contributing
16	25	36 Blue Mill Road	Contributing
16	26	34 Blue Mill Road	Contributing
17	33	67 Long Hill Road	Contributing
17	41	37 Long Hill Road	Contributing
19	8	67 Blue Mill Road	Contributing
19	9	65 Blue Mill Road	Contributing
19	10.01	61 Blue Mill Road	Contributing
19	11	55 Blue Mill Road	Contributing
23.02	17	158 Sand Spring Road	Contributing
23.03	1	162 Sand Spring Road	Contributing
23.03	2	164 Sand Spring Road	Contributing

Individual Properties of Historic Significance

Block	Lot	Street	Status
23.03	3	166 Sand Spring Road	Contributing
23.03	4	168 Sand Spring Road	Contributing
24	4	173 Sand Spring Road	Contributing
24	5	171 Sand Spring Road	Contributing
24	6	169 Sand Spring Road	Contributing
24	7	167 Sand Spring Road	Contributing
24	8	165 Sand Spring Road	Contributing
24	10	161 Sand Spring Road	Contributing
24	11	159 Sand Spring Road	Contributing
24	12	157 Sand Spring Road	Contributing
24	13	155 Sand Spring Road	Contributing
24	14	153 Sand Spring Road	Contributing
25	6	504 Mt Kemble Ave	Contributing
25	7	502 Mt Kemble Ave	Contributing
25	8	500 Mt Kemble Ave	Contributing
25	16	2 Jenks Road	Contributing
26	8	100 Glen Alpin Road	Contributing
26	9	98 Glen Alpin Road	Contributing
26	11	88 Glen Alpin Road	Contributing
26	12	76 Glen Alpin Road	Contributing
26.03	5	130 Glen Alpin Road	Contributing
27	8	535 Mt Kemble Ave	Contributing
27	15.01	60 Jenk's Hill Road	Contributing
27	18	29 Jenk's Hill Road	Contributing
32	4	1211 Mt Kemble Ave	Contributing
32	9	1111 Mt Kemble Ave	Contributing
33	5	995 Mt Kemble Ave	Contributing
33.03	1.01	1007 Mt Kemble Ave	Contributing
33.03	8	1109 Mt Kemble Ave	Contributing
33.03	9	1111 Mt Kemble Ave	Contributing
35.01	7	912 Mt Kemble Ave	Contributing
35.01	16	906 Mt Kemble Ave	Contributing
36	6	13 Primrose Trail	Contributing
36	8	26 Primrose Trail	Contributing
36	10	34 Primrose Trail	Contributing
36	11	36 Primrose Trail	Contributing
37	1	130 Bailey's Mill	Contributing
38	2	11 Lake Trail West	Contributing
38	4	17 Lake Trail West	Contributing
38	9	7 Lake Trail West	Contributing
38	10	5 Lake Trail West	Contributing
38	11	3 Lake Trail West	Contributing
39	1	19 Primrose Trail	Contributing
39	3	25 Primrose Trail	Contributing
39	4	29 Primrose Trail	Contributing
39	6	35 Primrose Trail	Contributing
39	15	33 Lake Trail West	Contributing
40	1	53 Primrose Trail	Contributing
41	2	4 Lake Trail West	Contributing
41	5	10 Lake Trail West	Contributing
41	10	22 Lake Trail West	Contributing
41	14	32 Lake Trail West	Contributing
41	15	34 Lake Trail West	Contributing
41	16	38 Lake Trail West	Contributing
41	17	40 Lake Trail West	Contributing
41	18	44 Lake Trail West	Contributing
41	19	48 Lake Trail West	Contributing

Individual Properties of Historic Significance

Block	Lot	Street	Status
41	21	56 Lake Trail West	Contributing
42	1	58 Lake Trail West	Contributing
42	4	2 Dogwood Drive	Contributing
43	5	19 Lake Trail East	Contributing
43	8	31 Lake Trail East	Contributing
43	10	37 Lake Trail East	Contributing
43	11	41 Lake Trail East	Contributing
43	12	45 Lake Trail East	Contributing
44	1	34 Lake Trail East	Contributing
44	6	40 Lake Trail East	Contributing
44	7	44 Lake Trail East	Contributing
44	14	17 Alpine Trail	Contributing
46	4	73 Bailey's Mill Road	Key Contributing
46	11.01	45 Bailey's Mill	Contributing
46.02	3	145 Bailey's Mill Road	Contributing
47	11	7 Youngs Road	Contributing
47	11.01	17 Youngs Road	Contributing
47	12.01	31 Youngs Road	Contributing
47	14	57 Youngs Road	Contributing
47	14.01	65 Youngs Road	Contributing
48	3	62 Youngs Road	Contributing
48	11	76 Youngs Road	Contributing
49	9	34 Lees Hill Road	Contributing
49	11.02	77 Glen Alpin Road	Contributing
50	4.02	33 Lindsley Road	Contributing
50	6	15 Lindsley Road	Contributing
52	1	2 Pleasant Plains Road	Contributing
52	3	70 Pleasant Plains Road	Contributing
54	9	94 Woodland Road	Contributing
54	12	122 Pleasantville Road	Contributing
55	1	83 Meyersville Road	Contributing
55	2	79 Meyersville Road	Contributing
55	3	75 Meyersville Road	Contributing
55	6.01	43 Meyersville Road	Contributing
56	3	90 Meyersville Road	Contributing
56	4	86 Meyersville Road	Contributing
56	5.01	84 Meyersville Road	Contributing
56	7	74 Meyersville Road	Contributing
56	9	56 Meyersville Road	Contributing
56	10	48 Meyersville Road	Contributing
56	11	46 Meyersville Road	Contributing
56	14	7 Woodland Road	Contributing
56	15	17 Woodland Road	Contributing
56	16	29 Woodland Road	Contributing
56	17	95 Woodland Road	Contributing